

DETAIL A
SCALE
1:6

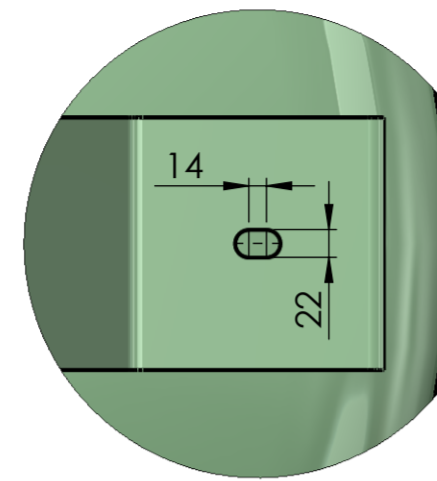
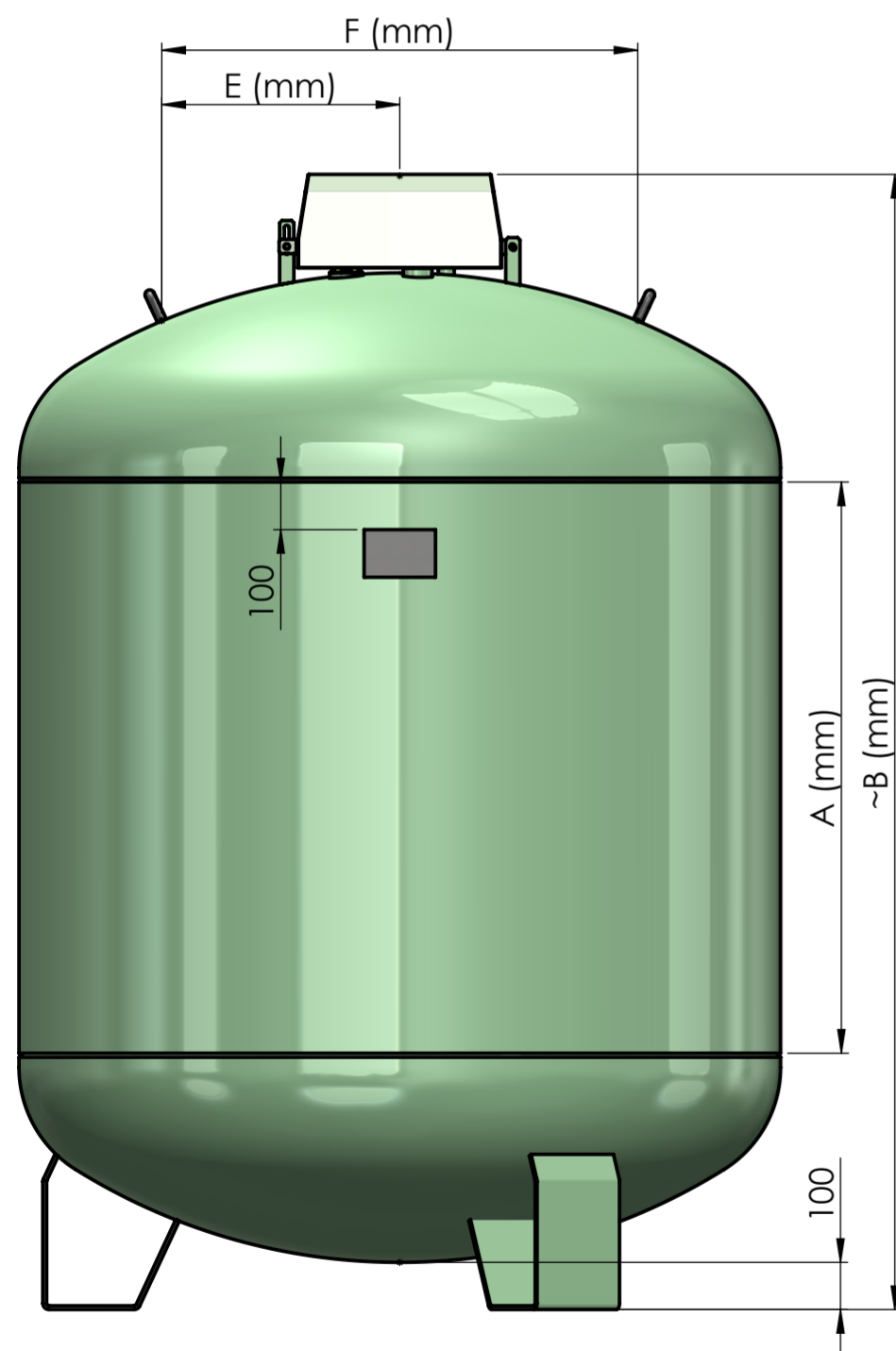
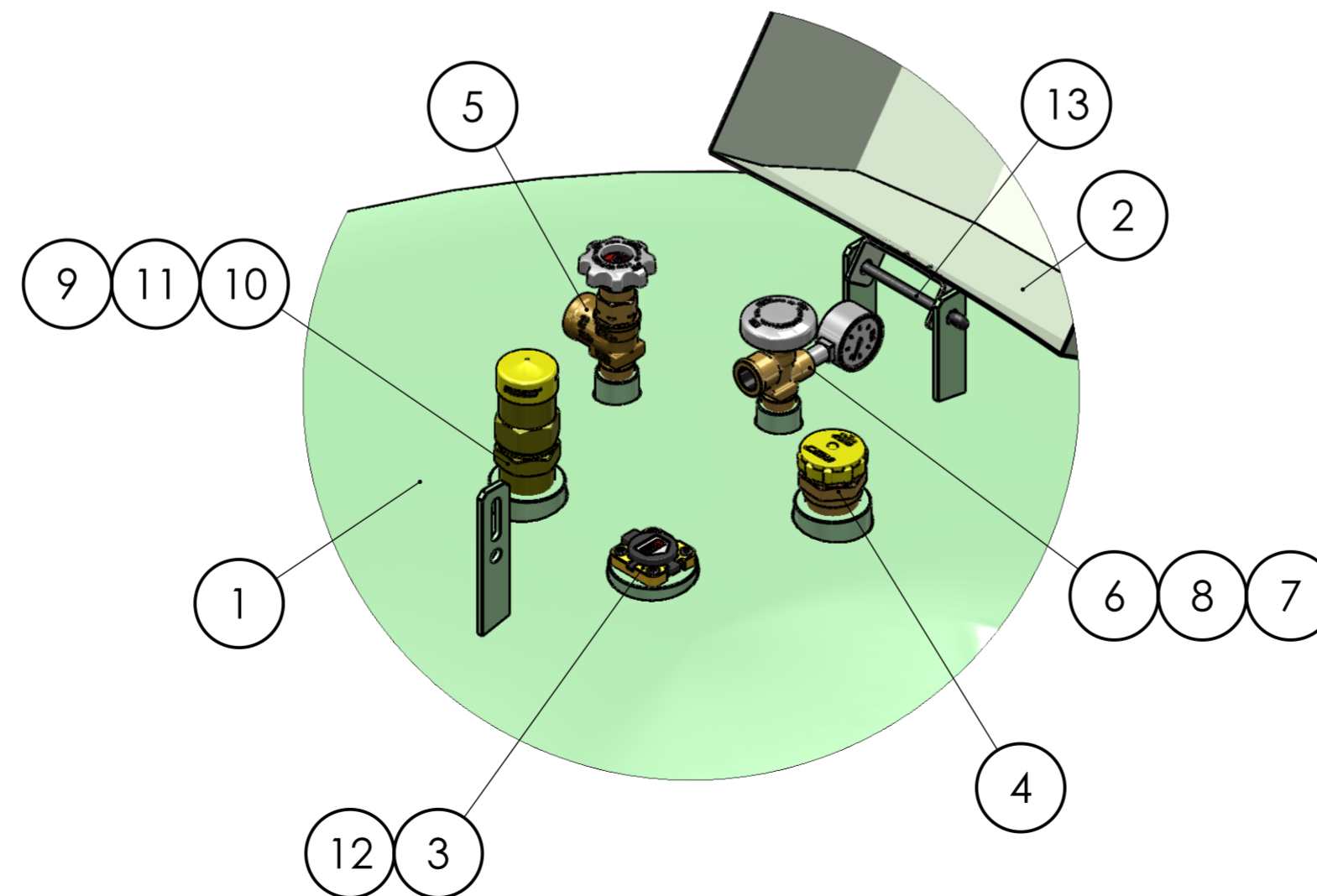

Table of tank volumes and basic dimensions								
D	Volume	A	B	E	F	P	R	Weight
1600	3500l	1200	2385	500	1000	200	1300	711
1600	3100l	1000	2185	500	1000	200	1300	647
1600	2800l	750	1935	500	1000	200	1300	569
1600	2100l	500	1685	500	1000	200	1300	491
2000	5250l	1000	2382	800	1600	200	1700	1014
2000	4500l	750	2132	800	1600	200	1700	915
2000	3700l	500	1882	800	1600	200	1700	817



SCALE
1:5



Bill of material					
Pos	Name	Pololovar	Preparations	Comment	Qt.
1	OVERGROUND TANK				1
2	PLASTIC HOOD				1
3	LEVEL GAUGE	C-FLEX ELG	MOSAZ / BRASS	JUNIOR	1
4	FILLING VALVE	L7579CT	MOSAZ / BRASS	5/4" M.NPT	1
5	WITHDRAWAL VALVE	7550PX	MOSAZ / BRASS	3/4" M.NPT	1
6	SERVICE VALVE	9101DK	MOSAZ / BRASS	3/4" M.NPT	1
7	PIPE TUBE	0906-450	MOSAZ / BRASS		1
8	MANOMETER 17,2 bar	1001440	OCEL - POZINK	1/4" M.NPT	1
9	PRESSURE RELIEF VALVE EXT.	RS3131	MOSAZ / BRASS	15,6bar	1
10	CHEK-LOK	CD31T	MOSAZ / BRASS	5/4" M.NPT	1
11	GASKET FOR PRESSURE VALVE	CD31-8	MOSAZ / BRASS		1
12	HEX. SOCKET HEAD SCREW	M6x25	A2	ISO 4762	4
13	SPLIT PIN	8x110	OCEL - POZINK	ISO 1234	1

Technical data			
DESIGN CODE	EN ISO 12542, AD2000, PED 2014/68/EU		
WORKING FLUID	PROPAN / BUTAN ACCORDING TO DIN 51622 / EN589		
MAX. WORKING PRESSURE	15,6 bar	16,7 bar	17,6 bar
RELIEF VALVE SET PRESSURE	15,6 bar	16,7 bar	17,6 bar
TESTING PRESSURE	22,3 bar	23,9 bar	25,2 bar
MAX./MIN ALLOW. OPER. WALL TEMPERATURE	-20(-40)/+40 °C	-20/+45 °C	-20(-30)/+50 °C
CORROSION ALLOWANCE	0	0	0
MAXIMUM FILLING	85% (82%,87%)	85% (82%,87%)	85% (82%,87%)
WELD FACTOR	1	1	1
MATERIAL	CARBON STEEL		
WELDED JOINTS EVALUATION ACCORDING TO AD-HP0			
ADDITIONAL WELDING MATERIALS	WELDS 135 - WIRE 1,2mm EN ISO 14341_A		
	WELDS 121 - WIRE 3,0mm EN ISO 14171_A		
	WELDS 141 - WIRE 2,0mm EN ISO 636_A		
SURFACE FINISH	SAND BLASTED Sa 2,5		
	POLYURETHANE COATING MIN. 120mik.		
	RAL 9010, RAL 6019, RAL 258 010		

1	Původní provedení	19.12.2023	HLAVÁČEK H.	TRPIŠOVSKÝ V.		
Rev.	Popis revize	Datum	Kreslil	Schválil		
Tabulka revizí						
Formát:	Měřitko:	Promítání:	Poznámky:	Tolerance:	List:	Listů:
A2	1:10		3500l	ISO 2768-mK, ISO 8015	1	1
 www.kadatec.cz			Název:	Nadzemní nádrž		Hmot.:
			Název(EN):	Overground tank		711.1
			Číslo výkresu:	V0002611		Revize:
						R1